

RUBBER LINE DIAPHRAGM

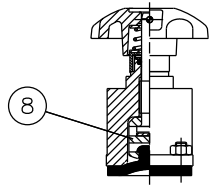

15-20mm

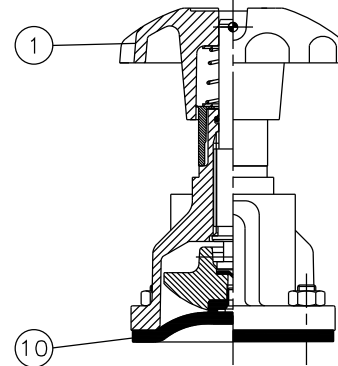

25-50mm

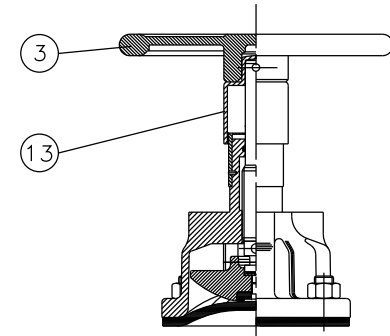

65-150mm

RUBBER/PTFE LINE DIAPHRAGM

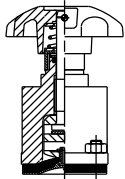

15-20mm

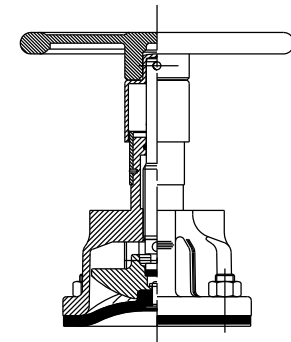
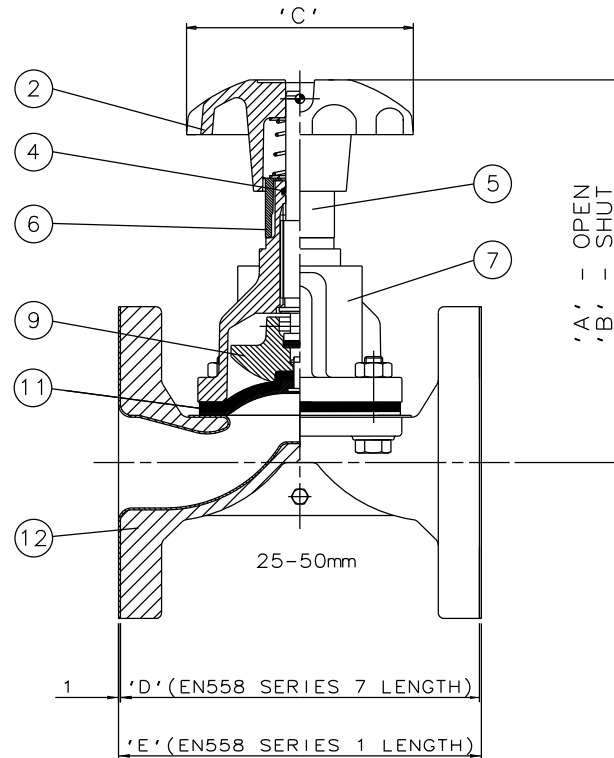

65-150mm

| Item | Component | Material | Lining | Where Used | Size(DN) | A | B | C | D | E |
|------|----------------|---------------|--------|------------|----------|-----|-----|------|-----|-----|
| 1 | HANDWHEEL | ABS | | 15mm-50mm | 15 | 115 | 109 | 62 | 110 | 130 |
| 2 | | CAST IRON | | 15mm-50mm | 20 | 106 | 100 | 62 | 119 | 150 |
| 3 | | CAST IRON | | 65mm-150mm | 25 | 130 | 120 | 80 | 129 | 160 |
| 4 | 'O'RING | VITON | | 15mm-150mm | 32 | 167 | 156 | 120* | 148 | 180 |
| 5 | SPINDLE | MILD STEEL | | | 40 | 185 | 169 | 120 | 161 | 200 |
| 6 | BONNET SLEEVE | POLYPROPYLENE | | | 50 | 200 | 177 | 120 | 192 | 230 |
| 7 | BONNET | S.G. IRON | | 15mm-50mm | 65 | 248 | 216 | 170 | 218 | 290 |
| 8 | | CAST IRON | | 65mm-150mm | 80 | 278 | 243 | 230 | 256 | 310 |
| 9 | COMPRESSOR | MILD STEEL | | 15mm-20mm | 100 | 347 | 300 | 280 | 307 | 350 |
| 10 | | CAST IRON | | 25mm-150mm | 125 | 419 | 353 | 280 | 358 | 400 |
| 11 | LINE DIAPHRAGM | RUBBER | | | 150 | 477 | 402 | 368 | 408 | 480 |
| 12 | BODY | CAST IRON | GLASS | | | | | | | |
| 13 | HANDWHEEL BOSS | POLYPROPYLENE | | 65mm-150mm | | | | | | |

*150mm FOR CAST IRON BODIES WITH PN16 FLANGES

The information on this sheet is Private and Confidential and is the property of Crane Process Flow Technologies Limited and must not be published directly or indirectly in any manner whatsoever without the written permission of the Company and must not be used in any way detrimental to their interests.
© Crane Process Flow Technologies

CRANE Process Flow Technologies
A Crane Co. Company

Saunders
The Science Inside

Title
GENERAL ARRANGEMENT OF 'A' TYPE RISING
HANDWHEEL SEALED BONNET ASSEMBLY (9100)
FITTED ON GLASS LINED FLANGED BODY

| | | | |
|---------------------------------------|--------------------|-------------------------------------|--------|
| Drawn NAW | Date 19.08.13 | UNCONTROLLED IN HARD COPY FORMAT | |
| Checked RND | Date 19.08.13 | | |
| First Angle Projection Method E | DO NOT SCALE | Drawing No. | Issue. |
| | | A-SG-CI-RHI-SEALED-GLASS | 1 |